

IBIS



ORDER FORM

The product picture shown may deviate from the base configuration. Ibis 7176/19 crash tested. Final configuration may differ from tested configuration.

Invoice address or customer number:

Customer number:
 Name:
 Street:
 Town: Postal code:
 Country:
 E-mail:
 Tel:

Delivery address: Deliver to Invoice address

Customer number:
 Name:
 Street:
 Town: Postal code:
 Country:
 E-mail:
 Tel:

Order information

Order Calculation Built-4-Me

Order date:
 Your reference:
 Reimbursement code:
 Revision 3.0, valid from 06-10-2023
 ORDER FORM ID 0181

User weight:

Max. user weight: 160 kg
 User weight: kg

Base price €

Customer Service: customerservice@sunrisemedical.nl

The base configuration below is indicated with 'basic'. If an alternative option is required please mark clearly by ticking the associated box.

THE CODES WHICH ARE MENTIONED BEHIND THE OPTIONS, ARE NOT ARTICLE NUMBERS. ALWAYS USE THESE CODES IN COMBINATION WITH THE ORDER FORM ID NUMBER MENTIONED ABOVE.

BASE FRAME

| | | option ID | Price |
|---|---|-----------|-------|
|  | 1 SEDEO PRO SEAT FRAME Sedeo Pro seat frame | Y01117 | Basic |
|  | 3 Sedeo Pro seat frame with seat shell backrest frame (frame only, no backrest cushion will be supplied) | Y01651 | |
|  | 4 Height adjustable push bar (not i.c.w. third party or seat shell backrest frame) | Y01126 | Basic |
|  | 5 Angle adjustable push bar, user weight < 120 kg (not i.c.w. third party or seat shell backrest frame or PowerSupport) | Y01127 | |
|  | 6 High seat post for SH 365 - 470 mm | Y00587 | Basic |
| | SEAT HEIGHT, EXCL. STANDARD CUSHION (70 MM), USER WEIGHT EXCL. | | |
| <input type="checkbox"/> | 320 mm (not i.c.w. SW 540 mm, SD 580 mm) | Y00575 | |
| <input type="checkbox"/> | 335 mm | Y00576 | |
| <input type="checkbox"/> | 350 mm | Y00577 | |
| <input type="checkbox"/> | 365 mm | Y00578 | |
| <input type="checkbox"/> | 380 mm | Y00579 | |
| <input type="checkbox"/> | 395 mm | Y00580 | |
| <input type="checkbox"/> | 410 mm | Y00581 | |
| <input type="checkbox"/> | 425 mm | Y00582 | Basic |
| <input type="checkbox"/> | 440 mm | Y00583 | |
| <input type="checkbox"/> | 455 mm | Y00584 | |
| <input type="checkbox"/> | 470 mm | Y00585 | |

SEAT CUSHIONS - CONTINUED

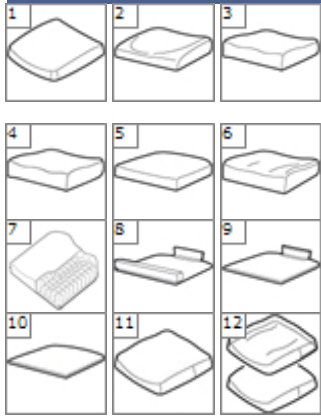

| | | | | |
|----|----|--|--------|-------|
| 1 | 1 | Profiled seat, 70 mm thick | Y01152 | Basic |
| 2 | 2 | Memory foam seat, 70 mm thick (only i.c.w. incontinence cover) | Y01153 | |
| 3 | 3 | Support seat, 100 mm thick | Y01154 | |
| 3 | 3 | Support seat TR with memory foam, 90 mm thick | Y01155 | |
| 4 | 4 | Form seat, 110 mm thick (only i.c.w. incontinence cover) | Y01531 | |
| 5 | 5 | Stabilizer seat, 90 mm thick | Y01156 | |
| 7 | 7 | | | |
| 8 | 8 | Pan seat with front (50 mm) and depth adjustable rear lip (not i.c.w. comfort cover) | Y01159 | |
| 8 | 8 | Pan seat with front (75 mm) and depth adjustable rear lip (not i.c.w. comfort cover) | Y01532 | |
| 9 | 9 | Board seat with rear pan (not i.c.w. comfort cover) | Y01160 | |
| | | Adaptive or other seat, choose desired deviations with adaptations | Y01162 | |
| | | Omit seat cushion | Y01163 | |
| 11 | 11 | Incontinence cover | Y01164 | Basic |
| 12 | 12 | Comfort cover | Y01165 | |
| 13 | 13 | Abduction support (not i.c.w. central legrest) | Y01166 | |



BACKRESTS

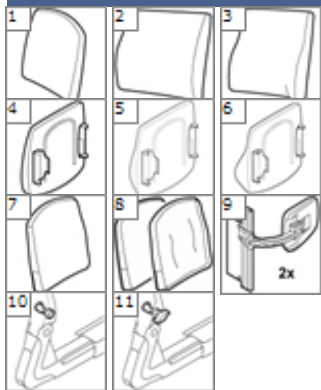

| | | option ID | Price | |
|--|----|---|--------|-------|
| WIDTH (BW) X HEIGHT (BH) COMFORT BACKREST CUSHION | | | | |
| (not i.c.w. third party or seat shell backrest frame) | | | | |
| | | 420 x 440 mm (BW 400 - 420 mm, BH 440 - 520 mm) (only i.c.w. backrest with | Y01527 | |
| | | 420 x 500 mm (BW 400 - 420 mm, BH 500 - 580 mm) | Y01173 | |
| | | 420 x 560 mm (BW 400 - 420 mm, BH 560 - 640 mm) | Y01174 | |
| | | 460 x 440 mm (BW 420 - 460 mm, BH 440 - 520 mm) (only i.c.w. backrest with | Y01528 | |
| | | 460 x 500 mm (BW 420 - 460 mm, BH 500 - 580 mm) | Y01176 | |
| | | 460 x 506 mm (BW 420 - 460 mm, BH 560 - 640 mm) | Y01177 | |
| | | 500 x 440 mm (BW 460 - 500 mm, BH 440 - 520 mm) (only i.c.w. backrest with | Y01529 | |
| | | 500 x 500 mm (BW 460 - 500 mm, BH 500 - 580 mm) | Y01179 | |
| | | 500 x 560 mm (BW 460 - 500 mm, BH 560 - 640 mm) | Y01180 | |
| | | 540 x 440 mm (BW 500 - 540 mm, BH 440 - 520 mm) (only i.c.w. backrest with | Y01530 | |
| | | 540 x 500 mm (BW 500 - 540 mm, BH 500 - 580 mm) | Y01182 | |
| | | 540 x 560 mm (BW 500 - 540 mm, BH 560 - 640 mm) | Y01183 | |
| CHOOSE ALSO BACKREST CUSHION COVER | | | | |
| (not i.c.w. third party or seat shell backrest frame) | | | | |
| 1 | 1 | Profiled backrest | Y01185 | Basic |
| 2 | 2 | Deep contour, passive backrest | Y01187 | |
| | | Backrest with adjustable straps passive | Y01488 | |
| | | Backrest with adjustable straps active | Y01489 | |
| 4 | 4 | Backrest Flexible, deep contour, passive, adjustable straps (note: not removable) | Y01190 | |
| 5 | 5 | Backrest Flexible, deep contour, active, adjustable straps (note: not removable) | Y01191 | |
| 6 | 6 | Backrest flexible, extra deep contour, active, adjustable straps (note: not removable) (not i.c.w. thoracic supports) | Y01520 | |
| | | Adaptive or other back, choose desired deviations with adaptations | Y01264 | |
| | | Omit backrest, only backrest mounting plates | Y01192 | |
| | | Omit backrest, only angle adjustable backrest mounting plates | Y01501 | |
| | | Omit backrest and omit backrest mounting plates | Y01502 | |
| 7 | 7 | Incontinence cover (not i.c.w. third party or seat shell backrest frame) | Y01193 | Basic |
| 8 | 8 | Comfort cover (not i.c.w. third party or seat shell backrest frame) | Y01194 | |
| 9 | 9 | Thoracic support (not i.c.w. third party or seat shell backrest frame), set | Y01195 | |
| 10 | 10 | Flip down backrest (not i.c.w. seat shell backrest frame) | Y01122 | Basic |
| 11 | 11 | Flip down backrest, operated by user (not i.c.w. seat shell backrest frame) | Y01123 | |
| | | option ID | Price | |

LEGRESTS SET

LEGRESTS

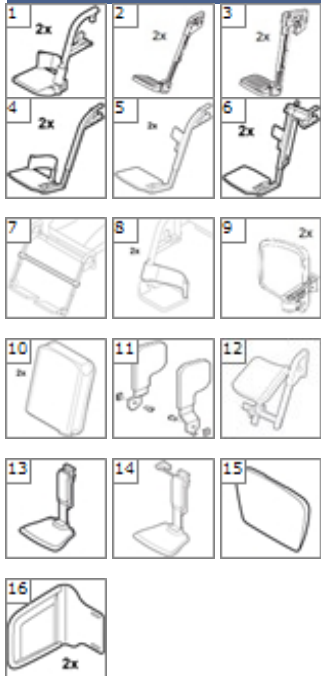

| | | | |
|---|--|--------|-------|
| 1 | Sedeo Lite standard legrests with heel strap (not i.c.w. legrest accessories) | Y01196 | |
| 1 | Sedeo Lite manually elevating legrests with calf support (not i.c.w. legrest | Y01197 | |
| 2 | Standard legrests | Y01198 | |
| 3 | Manually elevating legrests, choose also calf plate | Y01199 | |
| 4 | Standard heavy duty legrests with heel straps | Y01265 | |
| 5 | Standard heavy duty legrests with calf supports | Y01654 | |
| 6 | Comfort heavy duty legrests with calf supports | Y01266 | |
| | Mounting bracket only, no legrests | Y01477 | |
| LEGREST ACCESSORIES (not i.c.w. heavy duty legrests) | | | |
| | Widened footplate for SW 500 mm | Y01655 | |
| | Widened footplate for SW 540 mm | Y01656 | |
| 7 | Calf strap (only i.c.w. standard legrests) | Y01202 | |
| 8 | Heel straps | Y01203 | |
| 9 | Depth adjustable calf support, PU, set | Y01204 | |
| 10 | Upholstered calf support, set (only i.c.w. Depth adjustable calf support, PU, set) | Y01658 | |
| 11 | Knee pads (not i.c.w. padded side support, wedge-shape) | Y01205 | |
| 12 | Amputation support, right | Y01208 | |
| 12 | Amputation support, left | Y01207 | |
| CENTRAL LEGRESTS (not i.c.w. legrest set or legrest accessories) | | | |
| 13 | Central legrest (i.c.w. electrical adjustment choose calfrest) | Y01209 | |
| 14 | Manually elevating central legrest with length compensation, SH = or > 420 mm | Y01210 | Basic |
| | Omit central legrest | Y01211 | |
| CENTRAL LEGREST ACCESSORIES | | | |
| 15 | Central calf support | Y01212 | Basic |
| 16 | Central calf support with side support | Y01213 | |
| | Omit central calf support | Y01214 | |

ARMRESTS

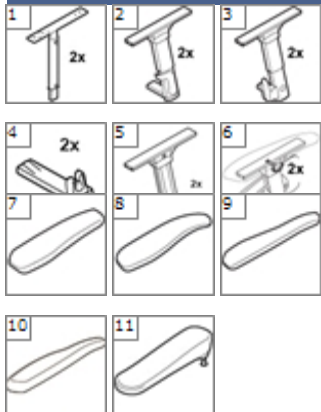

| | | option ID | Price |
|----|---|-----------|-------|
| 1 | Removable armrests | Y01215 | |
| 2 | Removable armrests with quick-lock | Y01216 | Basic |
| 3 | Flip-up armrests (only i.c.w. 12,5" or 16" rear wheels) | Y01217 | |
| 4 | Widened armrests (only i.c.w. 12,5" or 16" rear wheels and removable armrests) | Y01218 | |
| 5 | Raised armrests +100 mm (only i.c.w. removable armrests with quick-lock) | Y01504 | |
| 6 | Angle adjustment with quick-lock (not i.c.w. removable armrests) (i.c.w. worktop, armrest height + 20 mm) | Y01219 | |
| 7 | Armrest pad 300 mm, right (i.c.w. 20", 22" or 24" rear wheels limited tilt in space at | Y01223 | |
| 7 | Armrest pad 300 mm, left (i.c.w. 20", 22" or 24" rear wheels limited tilt in space at | Y01222 | |
| 8 | Armrest pad 400 mm, right (i.c.w. 20", 22" or 24" rear wheels limited tilt in space at | Y01221 | Basic |
| 8 | Armrest pad 400 mm, left (i.c.w. 20", 22" or 24" rear wheels limited tilt in space at | Y01220 | Basic |
| 9 | Armrest pad narrow, 400 mm, right | Y01225 | |
| 9 | Armrest pad narrow, 400 mm, left | Y01224 | |
| 10 | Armrest pad wide, 450 mm (i.c.w. flip-up armrest SW +20 mm, not i.c.w. SW 540 | Y01548 | |
| 10 | Armrest pad wide, 450 mm (i.c.w. flip-up armrest SW +20 mm, not i.c.w. SW 540 | Y01547 | |
| 11 | Hemiplegia armrest (not i.c.w. removable armrests or same entry side worktop & i.c.w. 20", 22" or 24" rear wheels limited tilt in space angle) (not i.c.w. WheelDrive), right | Y01227 | |
| 11 | Hemiplegia armrest (not i.c.w. removable armrests or same entry side worktop & i.c.w. 20", 22" or 24" rear wheels limited tilt in space angle) (not i.c.w. WheelDrive), left | Y01226 | |
| | Omit armrest pad, right | Y01229 | |
| | Omit armrest pad, left | Y01228 | |

SIDE CUSHIONS



| | | option ID | Price |
|---|--|-----------|-------|
| 1 | Side supports synthetic | Y01230 | |
| 2 | Side supports PU (SW -20 mm) | Y01231 | Basic |
| 3 | Padded side supports, wedge-shape (SW -80 mm) (not i.c.w. flip up armrest) | Y01232 | |
| | Omit side supports | Y01233 | |
| 4 | Thigh supports (not i.c.w. padded side support, wedge-shape) | Y01234 | |

| | | option ID | Price |
|---|---|-----------|-------|
| 1 | Headrest PU, small, choose also headrest socket | Y01235 | |

HEADRESTS

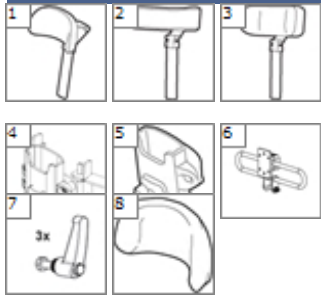

| | | | |
|--------------------------|---|---|--------|
| <input type="checkbox"/> | 2 | Headrest flexible, choose also headrest socket | Y01236 |
| <input type="checkbox"/> | 3 | Headrest large, choose also headrest socket | Y01237 |
| <input type="checkbox"/> | 4 | Headrest socket on backrest frame (not i.c.w. third party backrest frame) | Y01239 |
| <input type="checkbox"/> | 5 | Headrest socket on backrest frame (only i.c.w. third party backrest) | Y00333 |
| <input type="checkbox"/> | 6 | Width adjustable headrest bracket (only i.c.w. headrest) (not i.c.w. headrest) | Y01240 |
| <input type="checkbox"/> | 7 | Headrest bracket with quick-lock (only i.c.w. headrest) (not i.c.w. width adjustable) | Y01241 |
| <input type="checkbox"/> | 8 | Padded headrest cover for headrest PU small | Y01242 |

WORKTOPS

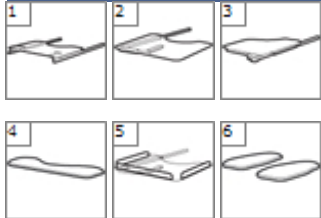

| | | option ID | Price |
|--|---|--|--------|
| I.C.W. 20", 22" OR 24" REAR WHEELS; WORKTOP LIMITS TILT IN SPACE AN | | | |
| <input type="checkbox"/> | 1 | Fixed worktop acrylic with two insert tubes, abdominal recess 110 mm | Y01249 |
| <input type="checkbox"/> | 2 | Folding worktop acrylic, abdominal recess 110 mm, entry tube right | Y01251 |
| <input type="checkbox"/> | 2 | Folding worktop acrylic, abdominal recess 110 mm, entry tube left | Y01250 |
| <input type="checkbox"/> | 3 | Folding worktop half, acrylic, entry tube right | Y01268 |
| <input type="checkbox"/> | 3 | Folding worktop half, acrylic, entry tube left | Y01267 |
| WORKTOP TOGETHER WITH | | | |
| <input type="checkbox"/> | 4 | Partial padding (not i.c.w. elbow pads) | Y01252 |
| <input type="checkbox"/> | 5 | Raised edges acrylic | Y01253 |
| <input type="checkbox"/> | 6 | Elbow pads (not i.c.w. partial padding), set | Y01254 |

ACCESSORIES

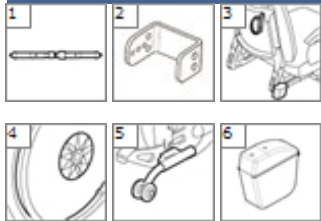

| | | option ID | Price | |
|--------------------------|---|--|--------|-------|
| <input type="checkbox"/> | 1 | Lap strap | Y01255 | |
| <input type="checkbox"/> | 1 | Lap strap longer | Y01256 | |
| <input type="checkbox"/> | 2 | Lap strap bracket for SW 500 - 540 mm | Y01546 | |
| <input type="checkbox"/> | 3 | Cane/crutch holder for 2 walking canes | Y00012 | |
| <input type="checkbox"/> | 4 | Spoke protectors 20" | Y00032 | |
| <input type="checkbox"/> | 4 | Spoke protectors 22" | Y00033 | |
| <input type="checkbox"/> | 4 | Spoke protectors 24" | Y00034 | |
| <input type="checkbox"/> | 5 | Anti-tip bracket, flip-up, set (not i.c.w. WheelDrive) | Y00005 | Basic |
| <input type="checkbox"/> | | Anti static cable | Y01544 | |
| <input type="checkbox"/> | | Bierman transport lock (not i.c.w. WheelDrive) | Y00010 | |
| <input type="checkbox"/> | 6 | Armrest bag (not i.c.w. fixed worktop acrylic with two insert tubes or 20, 22 or 24" | Y01423 | |

BATTERIES & CHARGERS

| | | option ID | Price |
|--------------------------|--|-------------------------------------|--------|
| <input type="checkbox"/> | | Charger 24V - 3,4A for PowerSupport | Y01108 |

ADAPTATIONS



| | | option ID | Price |
|-----------------------------------|---|--|--------|
| BASE FRAME | | | |
| <input type="checkbox"/> | 1 | Elevation set for castors, elevation 25 mm (not i.c.w. 12,5" or 20" wheels) | Y02000 |
| <input type="checkbox"/> | 2 | Seat post extended for 600 mm seat height (specify dimensions) | Y02004 |
| <input type="checkbox"/> | | Base frame width reduction by 40 mm for PowerSupport | Y02102 |
| <input type="checkbox"/> | 3 | Parking brake for attendant use 12.5" (not i.c.w. coupled footbrake) | Y02047 |
| <input type="checkbox"/> | 3 | Parking brake for attendant use for PowerSupport (not i.c.w. coupled footbrake) | Y02048 |
| <input type="checkbox"/> | | Parking brake for attendant use i.c.w. standard push brake, 20" drum brake | Y02046 |
| <input type="checkbox"/> | | Parking brake for attendant use i.c.w. standard push brake, 22" drum brake wheels (not i.c.w. seat shell backrest frame) | Y02226 |
| <input type="checkbox"/> | | Parking brake for attendant use i.c.w. standard push brake, 24" drum brake wheels (not i.c.w. seat shell backrest frame or WheelDrive) | Y02227 |
| ADJUSTMENTS & LIGHTING | | | |
| <input type="checkbox"/> | 4 | Tilt, negative, 5°, stroke remains the same | Y02039 |
| <input type="checkbox"/> | | Electrical backrest adjustment, batteries included, choose also charger 24V - 1A | Y00386 |
| <input type="checkbox"/> | | Electrical backrest adjustment i.c.w. PowerSupport (not i.c.w. seat shell backrest) | Y00504 |
| <input type="checkbox"/> | | Electrical tilt adjustment, batteries included, choose also charger 24V - 1A (not i.c.w. seat shell backrest frame or WheelDrive) | Y00399 |
| <input type="checkbox"/> | | Electrical tilt i.c.w. PowerSupport (not i.c.w. seat shell backrest frame) | Y00505 |
| BATTERY & CHARGERS | | | |
| <input type="checkbox"/> | | Charger 24V - 1A for electrical adjustments (not i.c.w. seat shell backrest frame) | Y01110 |

| COMMENTS | |
|----------|--|
| | |
| | |
| | |
| | |
| | |
| | |
| | |
| | |

Sunrise



Sunrise Medical HCM B.V.
Vossenbeemd 104
5705 CL Helmond
The Netherlands
Tel. +31 (0)492 593888
Fax: +31 (0)492 594497
E-mail: customerservice@sunrisemedical.nl
www.sunrisemedical.nl