



Leckey Pronestander

CE

Name	
Date:	
Email	
Contact Number	
Invoice Address	
Delivery Address	

Quote Order

Purchase Order	
----------------	--



	Item Code	Description	Quantity	Price
Frame				
<input type="checkbox"/>	LPS/1-MW	Size 1 Pronestander - Meadow		XXX
<input type="checkbox"/>	LPS/2-MB	Size 2 Pronestander - Mondeo Blue		XXX
<input type="checkbox"/>	LPS/3-MB	Size 3 Pronestander - Mondeo Blue		XXX
Pelvic Band				
<input type="checkbox"/>	LPS/1/B-MW	Pronestander Pelvic Band - size 1 - Meadow		XXX
<input type="checkbox"/>	LPS/2/B-MB	Pronestander Pelvic Band - size 2 - Mondeo Blue		XXX
<input type="checkbox"/>	LPS/3/B-MB	Pronestander Pelvic Band - size 3 - Mondeo Blue		XXX
<input type="checkbox"/>	LFS/1/B-MW	Freestander Pelvic Band - size 1 - Meadow		XXX
<input type="checkbox"/>	LFS/2/B-MB	Freestander Pelvic Band - size 2 - Mondeo Blue		XXX
<input type="checkbox"/>	LFS/3/B-MB	Freestander Pelvic Band - size 3 - Mondeo Blue		XXX
Soft Knees				
<input type="checkbox"/>	LPS/1/K-MW	Freestander/Pronestander Upholstered Kneecups - size 1 - Meadow		XXX
<input type="checkbox"/>	LPS/2/K-MB	Freestander/Pronestander Upholstered Kneecups - size 2 - Mondeo Blue		XXX
<input type="checkbox"/>	LPS/3/K-MB	Freestander/Pronestander Upholstered Kneecups - size 3 - Mondeo Blue		XXX
<input type="checkbox"/>	LPS/4/K-MB	Freestander/Pronestander Upholstered Kneecups - size 4 - Mondeo Blue		XXX

Foot Supports



Sandals

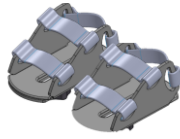

Open-back sandals



Booties



Ankle Huggers



Ankle Wraps

<input type="checkbox"/>	152-1600	Sandals Size 1		XXX
<input type="checkbox"/>	152-2600	Sandals Size 2		XXX
<input type="checkbox"/>	152-3600	Sandals Size 3		XXX
<input type="checkbox"/>	LHZ/1/100	Size 1 open-back sandals		XXX
<input type="checkbox"/>	LHZ/2/100	Size 2 open-back sandals		XXX
<input type="checkbox"/>	LHZ/3/100	Size 3 open-back sandals		XXX
<input type="checkbox"/>	LHZ/4/100	Size 4 open-back sandals		XXX
<input type="checkbox"/>	150-1852	Extra Small Booties		XXX
<input type="checkbox"/>	AH01	Ankle Huggers		XXX
<input type="checkbox"/>	173-2305	Small Ankle Wraps (use with sandals)		XXX
<input type="checkbox"/>	173-3305	Large Ankle Wraps (use with sandals)		XXX
<input type="checkbox"/>	117-787	1Inch Footplate Raiser for Split Footplate		XXX

Technical data	Size 1		Size 2		Size 3	
Age (years)	1.5 – 5		4 – 10		9 – 18	
Body height (cm/inches)	Min.	80/31.5	Min.	110/43.3	Min.	140/55.1
	Max.	115/45.3	Max.	145/57	Max.	185/72.8
User weight (kg/lbs)	60/132		80/176		90/198	
Chest pad height (cm/inches)	Min.	47/18.5	Min.	68/26.8	Min.	97/38.4
	Max.	68/26.8	Max.	98/38.4	Max.	114/53.1
Width between chest supports (cm/inches)	Min.	15/6	Min.	20/8	Min.	25/10
	Max.	25/10	Max.	31/12	Max.	36/14