

# Fotplatta vinkel- och djupjusterbar

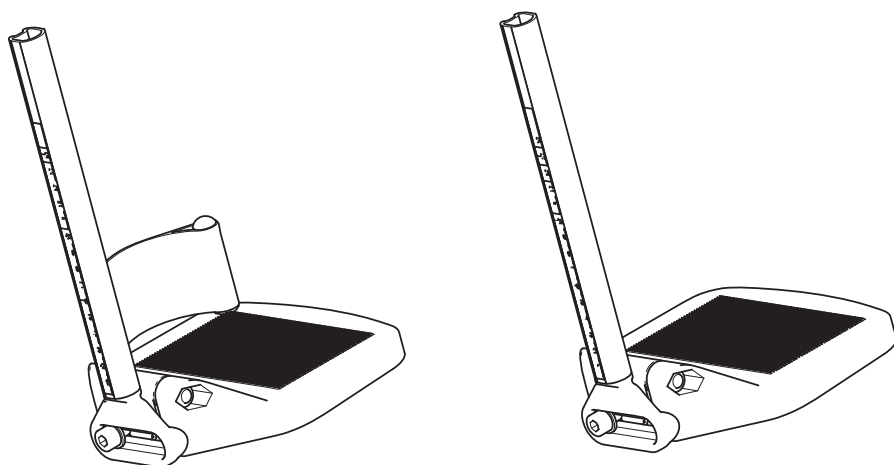

Sitsbredd	Med hälband		Utan hälband	
	Höger	Vänster	Höger	Vänster
36	<input type="checkbox"/> 3003464	<input type="checkbox"/> 3003465	<input type="checkbox"/> 3003452	<input type="checkbox"/> 3003453
39	<input type="checkbox"/> 3003466	<input type="checkbox"/> 3003467	<input type="checkbox"/> 3003454	<input type="checkbox"/> 3003455
42	<input type="checkbox"/> 3003468	<input type="checkbox"/> 3003469	<input type="checkbox"/> 3003456	<input type="checkbox"/> 3003457
45	<input type="checkbox"/> 3003470	<input type="checkbox"/> 3003471	<input type="checkbox"/> 3003458	<input type="checkbox"/> 3003459
48	<input type="checkbox"/> 3003472	<input type="checkbox"/> 3003473	<input type="checkbox"/> 3003460	<input type="checkbox"/> 3003461
51	<input type="checkbox"/> 3003474	<input type="checkbox"/> 3003475	<input type="checkbox"/> 3003462	<input type="checkbox"/> 3003463

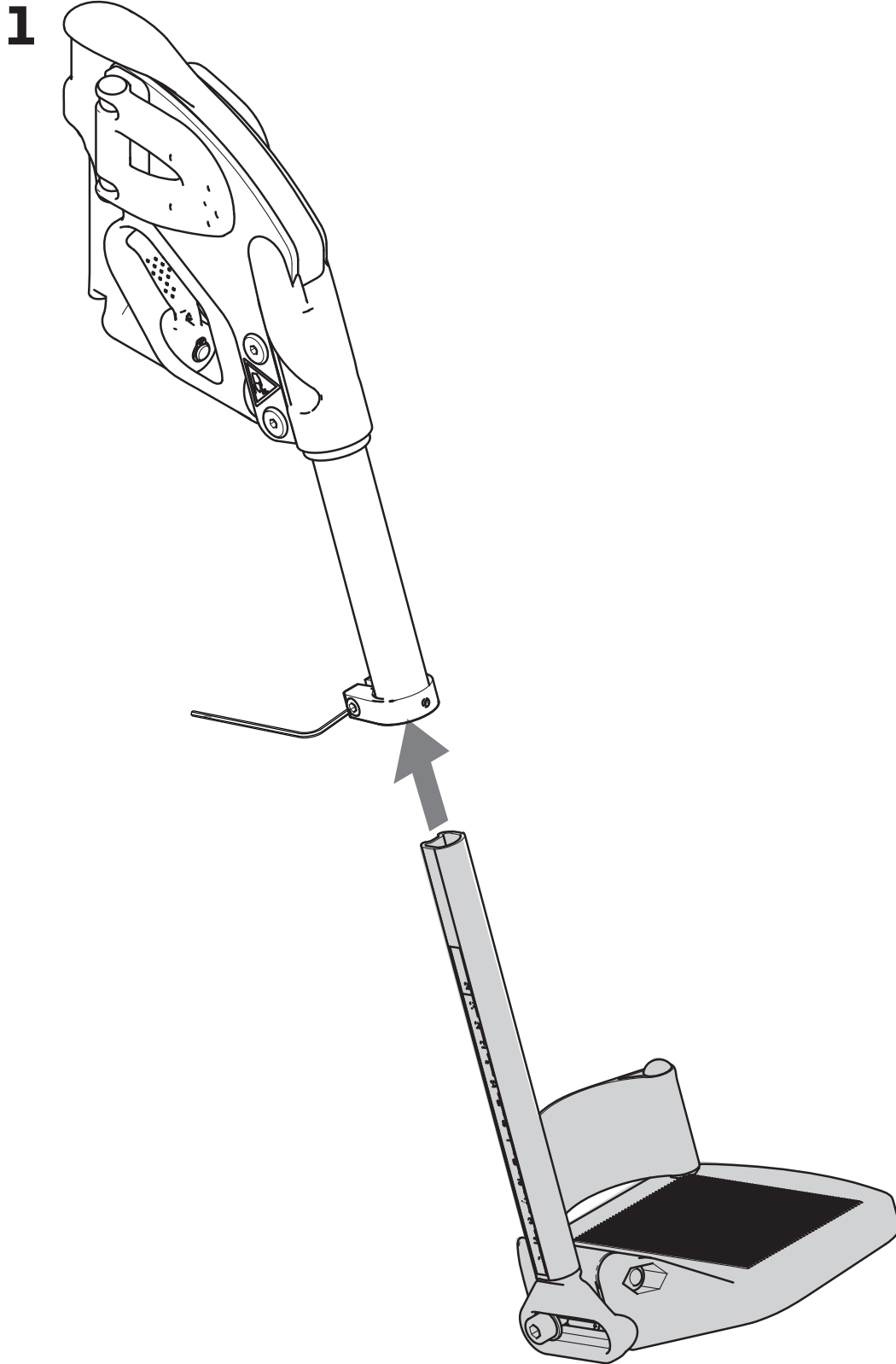

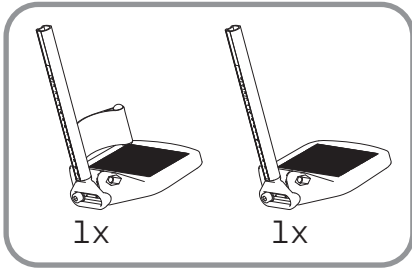
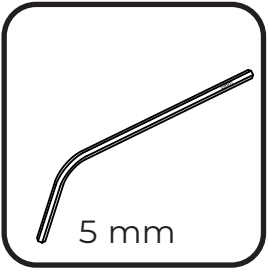

2

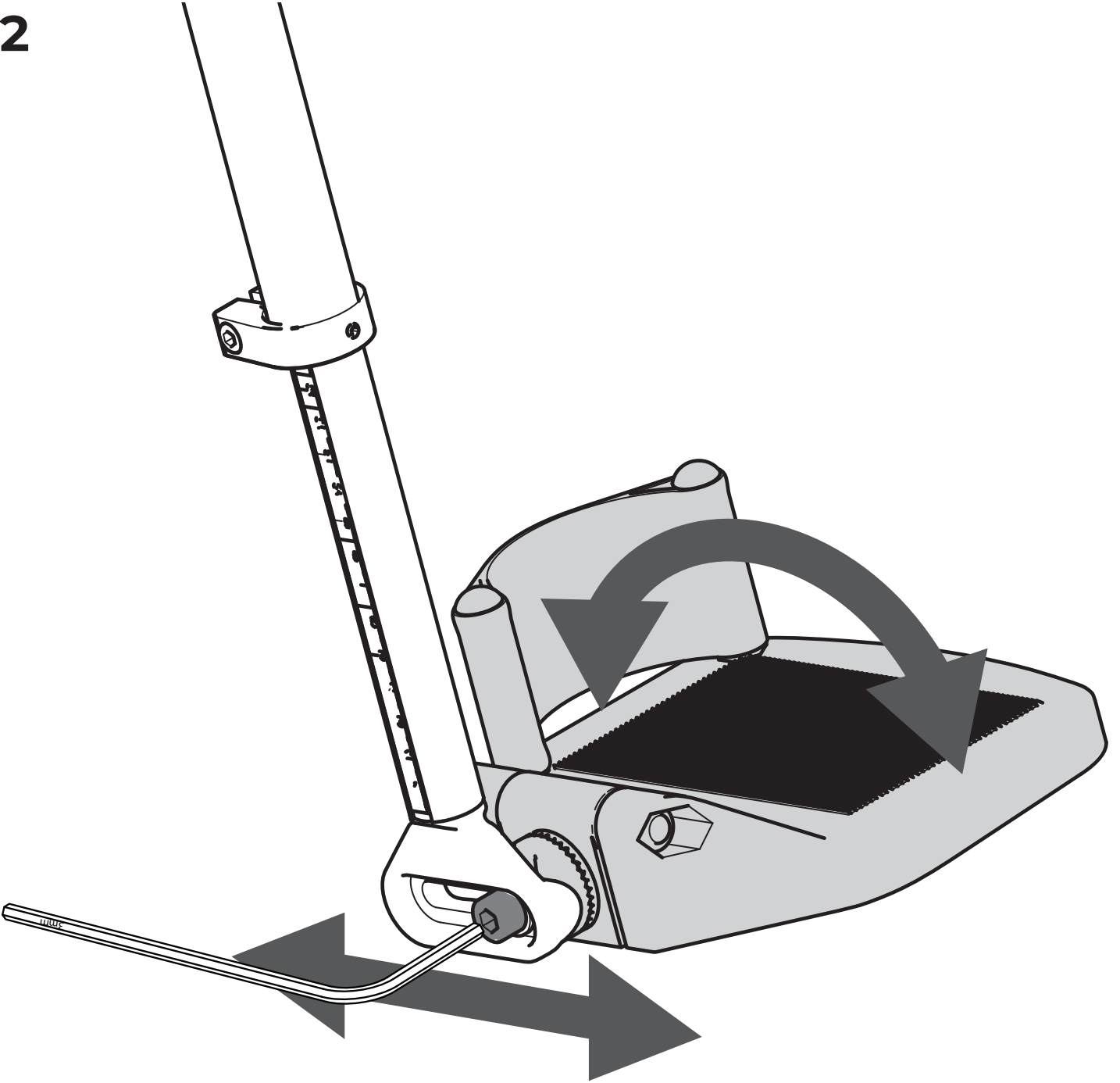



Sunrise Medical HCM B.V.  
Vossenbeemd 104  
5705 CL Helmond  
The Netherlands

T: +31 (0)492 59 38 88  
E: [customerservice@sunrisemedical.nl](mailto:customerservice@sunrisemedical.nl)  
[www.SunriseMedical.eu](http://www.SunriseMedical.eu)



Sunrise Medical AB  
Neongatan 5  
431 53 Mölndal  
Sverige

T: +46 (0) 31 748 37 00  
E: [post@sunrisemedical.se](mailto:post@sunrisemedical.se)  
[www.sunrisemedical.se](http://www.sunrisemedical.se)