

ASSEMBLY INSTRUCTION

Footplate

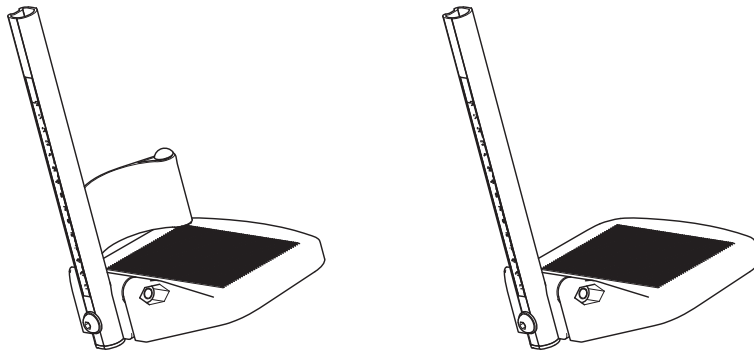

| Seat width | With heelstrap | | Without heelstrap | |
|------------|----------------------------------|----------------------------------|----------------------------------|----------------------------------|
| | RHS | LHS | RHS | LHS |
| 36 | <input type="checkbox"/> 3003485 | <input type="checkbox"/> 3003486 | <input type="checkbox"/> 3043404 | <input type="checkbox"/> 3043405 |
| 39 | <input type="checkbox"/> 3003487 | <input type="checkbox"/> 3003488 | <input type="checkbox"/> 3043406 | <input type="checkbox"/> 3043407 |
| 42 | <input type="checkbox"/> 3003489 | <input type="checkbox"/> 3003490 | <input type="checkbox"/> 3043408 | <input type="checkbox"/> 3043409 |
| 45 | <input type="checkbox"/> 3003491 | <input type="checkbox"/> 3003492 | <input type="checkbox"/> 3043410 | <input type="checkbox"/> 3043411 |
| 48 | <input type="checkbox"/> 3003493 | <input type="checkbox"/> 3003494 | <input type="checkbox"/> 3043412 | <input type="checkbox"/> 3043413 |
| 51 | <input type="checkbox"/> 3003495 | <input type="checkbox"/> 3003496 | <input type="checkbox"/> 3043414 | <input type="checkbox"/> 3043415 |



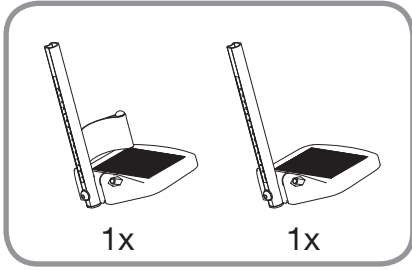
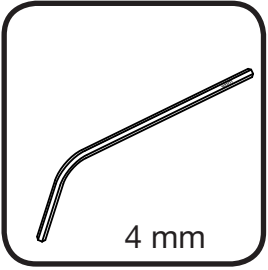

1

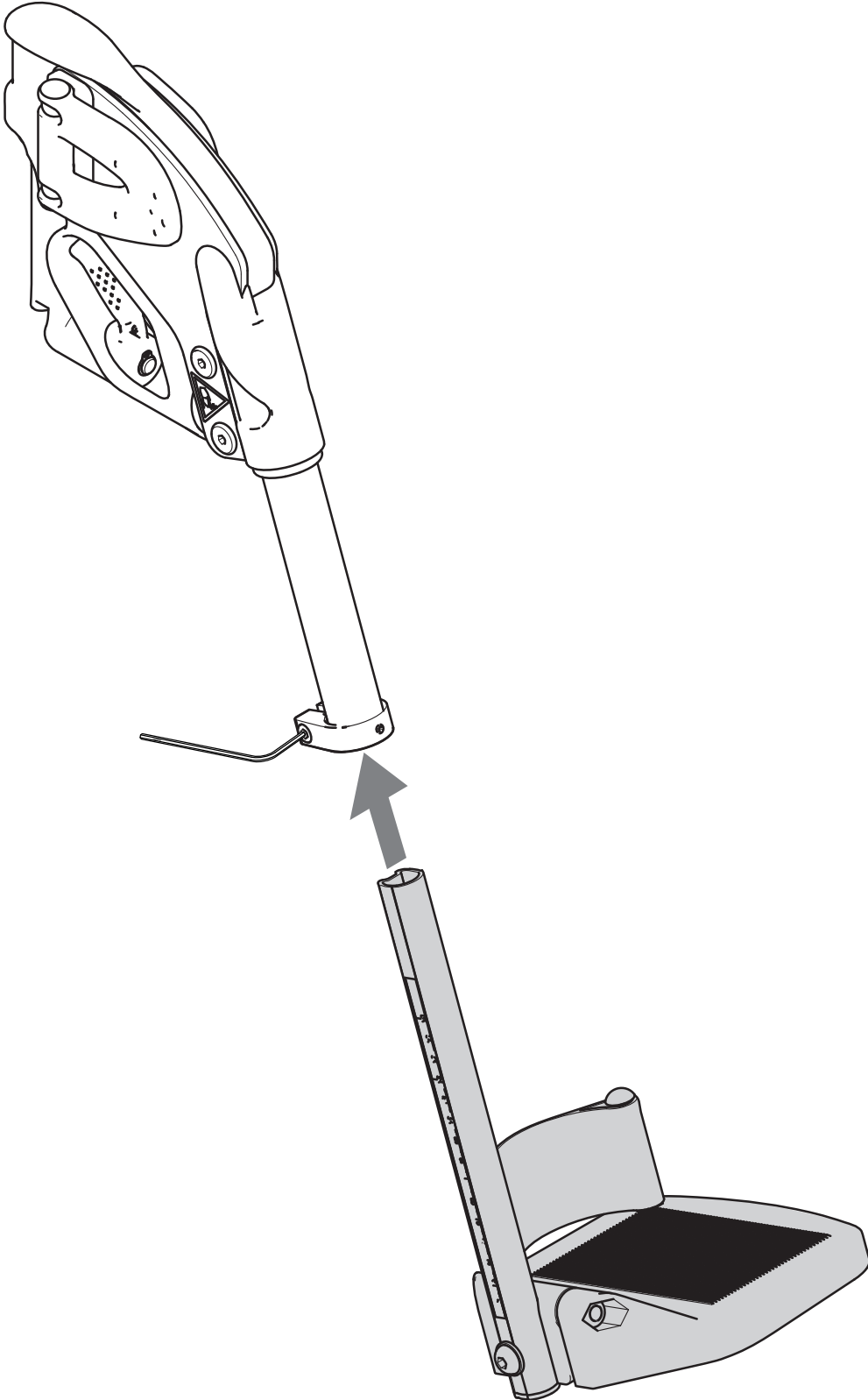

2

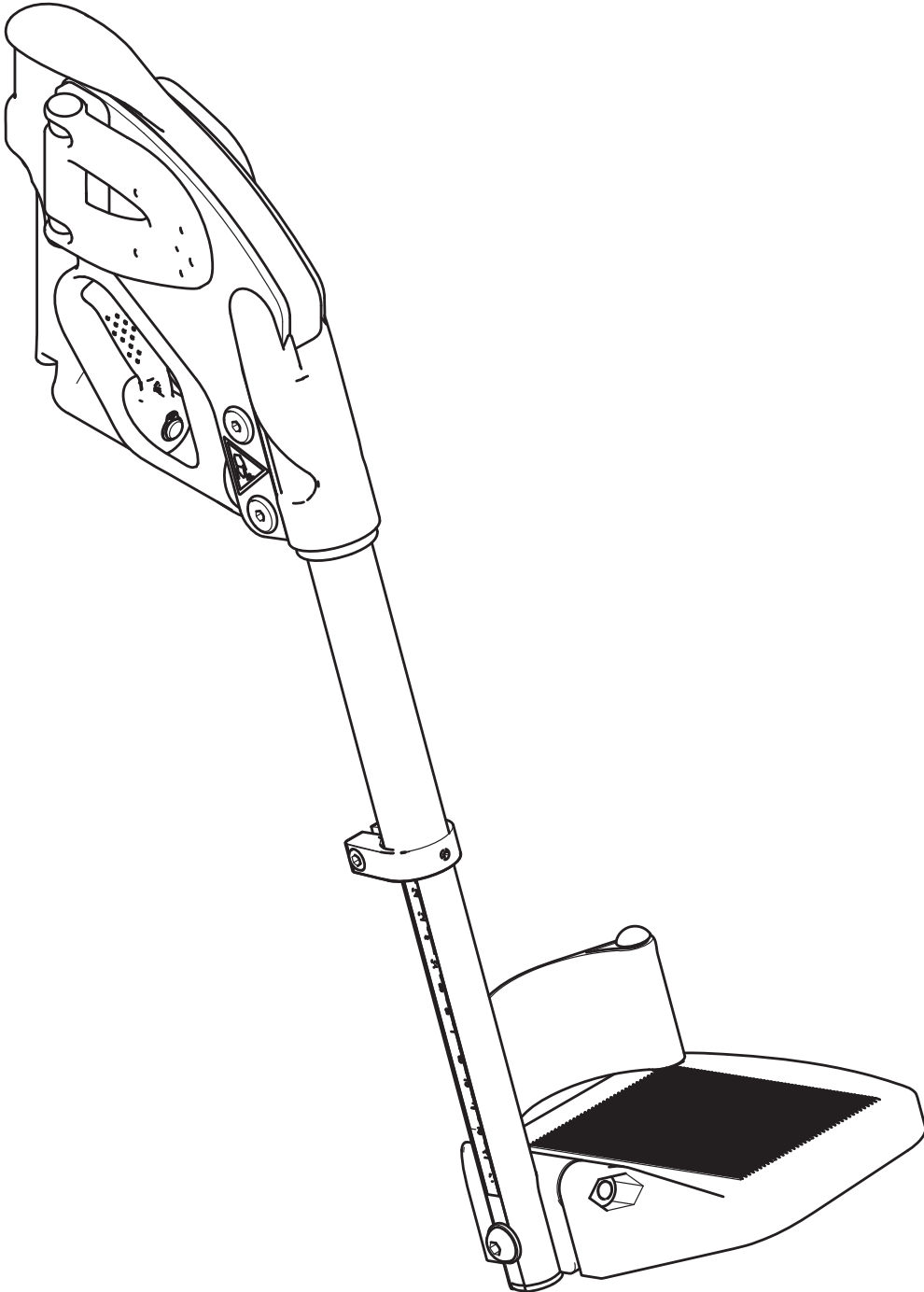



Sunrise Medical HCM B.V.
Vossenbeemd 104
5705 CL Helmond
The Netherlands

T: +31 (0)492 593 888
customerservice@sunrisemedical.nl
www.SunriseMedical.eu