

Deliver to:

Name:

Street:

Town: Postal code:

E-Mail:

Tel: Fax:

Deliver to:

Name:

Street:

Town: Postal code:

E-Mail:

Tel: Fax:

UK  
CA

Order date:

Purchase order:

Number required:

CE

Marked for:

Sunrise order no:

All Sunrise Medical wheelchairs and powerchairs are compatible with **JAY** cushions and backrests.

**JAY**

● = Standard □ = Cost option ○ = No cost option

Customer Services fax number **0845 605 66 89**

Customer Services email **orders@sunmed.co.uk**

**Max. user weight: 125kg // 140 kg (2)**

**USER WEIGHT**  kg

Mandatory information to ensure correct configuration

### Transportation Approved

Details of options can be found in the Quickie Manual Wheelchair Accessory Guide

**Part no.: 65100001**

**AGN01**

Please consult our colour catalogue, to review your colour choice at the end of the order form

### Base Price

**£2,250**

## CLIENT MEASUREMENTS

		Seat Width in cm										
		30 cm	32 cm	34 cm	36 cm	38 cm	40 cm	42 cm	44 cm	46 cm	48 cm	50 cm
Seat Depth in cm	32 cm	<input type="radio"/>	<input type="radio"/>	<input type="radio"/>	<input type="radio"/>	<input type="radio"/>	<input type="radio"/>	<input type="radio"/>	<input type="radio"/>	<input type="radio"/>	<input type="radio"/>	<input type="radio"/>
	34 cm	<input type="radio"/>	<input type="radio"/>	<input type="radio"/>	<input type="radio"/>	<input type="radio"/>	<input type="radio"/>	<input type="radio"/>	<input type="radio"/>	<input type="radio"/>	<input type="radio"/>	<input type="radio"/>
	36 cm	<input type="radio"/>	<input type="radio"/>	<input type="radio"/>	<input type="radio"/>	<input type="radio"/>	<input type="radio"/>	<input type="radio"/>	<input type="radio"/>	<input type="radio"/>	<input type="radio"/>	<input type="radio"/>
	38 cm	<input type="radio"/>	<input type="radio"/>	<input type="radio"/>	<input type="radio"/>	<input type="radio"/>	<input type="radio"/>	<input type="radio"/>	<input type="radio"/>	<input type="radio"/>	<input type="radio"/>	<input type="radio"/>
	40 cm	<input type="radio"/>	<input type="radio"/>	<input type="radio"/>	<input type="radio"/>	<input type="radio"/>	<input type="radio"/>	<input type="radio"/>	<input type="radio"/>	<input type="radio"/>	<input type="radio"/>	<input type="radio"/>
	42 cm	<input type="radio"/>	<input type="radio"/>	<input type="radio"/>	<input type="radio"/>	<input type="radio"/>	<input type="radio"/>	<input type="radio"/>	<input type="radio"/>	<input type="radio"/>	<input type="radio"/>	<input type="radio"/>
	44 cm	<input type="radio"/>	<input type="radio"/>	<input type="radio"/>	<input type="radio"/>	<input type="radio"/>	<input type="radio"/>	<input type="radio"/>	<input type="radio"/>	<input type="radio"/>	<input type="radio"/>	<input type="radio"/>
	46 cm	<input type="radio"/>	<input type="radio"/>	<input type="radio"/>	<input type="radio"/>	<input type="radio"/>	<input type="radio"/>	<input type="radio"/>	<input type="radio"/>	<input type="radio"/>	<input type="radio"/>	<input type="radio"/>
	48 cm	<input type="radio"/>	<input type="radio"/>	<input type="radio"/>	<input type="radio"/>	<input type="radio"/>	<input type="radio"/>	<input type="radio"/>	<input type="radio"/>	<input type="radio"/>	<input type="radio"/>	<input type="radio"/>
	50 cm	<input type="radio"/>	<input type="radio"/>	<input type="radio"/>	<input type="radio"/>	<input type="radio"/>	<input type="radio"/>	<input type="radio"/>	<input type="radio"/>	<input type="radio"/>	<input type="radio"/>	<input type="radio"/>
	52 cm	<input type="radio"/>	<input type="radio"/>	<input type="radio"/>	<input type="radio"/>	<input type="radio"/>	<input type="radio"/>	<input type="radio"/>	<input type="radio"/>	<input type="radio"/>	<input type="radio"/>	<input type="radio"/>

All measurements are in cm and without a cushion

		Front Seat Height in cm								
		Fork type	45	46	47	48	49	50	51	52
Front Castor	3"	111mm	<input type="radio"/>	<input type="radio"/>	<input type="radio"/>	<input type="radio"/>	<input type="radio"/>	<input type="radio"/>	<input type="radio"/>	<input type="radio"/>
		123mm (1)	<input type="radio"/>	<input type="radio"/>	<input type="radio"/>	<input type="radio"/>	<input type="radio"/>	<input type="radio"/>	<input type="radio"/>	<input type="radio"/>
	4"	111mm	<input type="radio"/>	<input type="radio"/>	<input type="radio"/>	<input type="radio"/>	<input type="radio"/>	<input type="radio"/>	<input type="radio"/>	<input type="radio"/>
		123mm (1)	<input type="radio"/>	<input type="radio"/>	<input type="radio"/>	<input type="radio"/>	<input type="radio"/>	<input type="radio"/>	<input type="radio"/>	<input type="radio"/>
	5"	Frog leg (1)	<input type="radio"/>	<input type="radio"/>	<input type="radio"/>	<input type="radio"/>	<input type="radio"/>	<input type="radio"/>	<input type="radio"/>	<input type="radio"/>
		111mm	<input type="radio"/>	<input type="radio"/>	<input type="radio"/>	<input type="radio"/>	<input type="radio"/>	<input type="radio"/>	<input type="radio"/>	<input type="radio"/>
		123mm (1)	<input type="radio"/>	<input type="radio"/>	<input type="radio"/>	<input type="radio"/>	<input type="radio"/>	<input type="radio"/>	<input type="radio"/>	<input type="radio"/>
	5"	Frog leg (1)	<input type="radio"/>	<input type="radio"/>	<input type="radio"/>	<input type="radio"/>	<input type="radio"/>	<input type="radio"/>	<input type="radio"/>	<input type="radio"/>
		123mm (1)	<input type="radio"/>	<input type="radio"/>	<input type="radio"/>	<input type="radio"/>	<input type="radio"/>	<input type="radio"/>	<input type="radio"/>	<input type="radio"/>

Your rear seat height can only be between 0cm and 13cm below your front seat height:  
i.e. rear seat height CANNOT be above front seat height.  
i.e. rear seat height CANNOT be more than 13cm below front seat height.  
More info, see page 2

		Rear seat height in cm															
		Rear Wheels	34	35	36	37	38	39	40	41	42	43	44	45	46	47	48
	22"	<input type="radio"/>	<input type="radio"/>	<input type="radio"/>	<input type="radio"/>	<input type="radio"/>	<input type="radio"/>	<input type="radio"/>	<input type="radio"/>	<input type="radio"/>	<input type="radio"/>	<input type="radio"/>	<input type="radio"/>	<input type="radio"/>	<input type="radio"/>	<input type="radio"/>	<input type="radio"/>
	24"	<input type="radio"/>	<input type="radio"/>	<input type="radio"/>	<input type="radio"/>	<input type="radio"/>	<input type="radio"/>	<input type="radio"/>	<input type="radio"/>	<input type="radio"/>	<input type="radio"/>	<input type="radio"/>	<input type="radio"/>	<input type="radio"/>	<input type="radio"/>	<input type="radio"/>	<input type="radio"/>
	25"	<input type="radio"/>	<input type="radio"/>	<input type="radio"/>	<input type="radio"/>	<input type="radio"/>	<input type="radio"/>	<input type="radio"/>	<input type="radio"/>	<input type="radio"/>	<input type="radio"/>	<input type="radio"/>	<input type="radio"/>	<input type="radio"/>	<input type="radio"/>	<input type="radio"/>	<input type="radio"/>
	26"	<input type="radio"/>	<input type="radio"/>	<input type="radio"/>	<input type="radio"/>	<input type="radio"/>	<input type="radio"/>	<input type="radio"/>	<input type="radio"/>	<input type="radio"/>	<input type="radio"/>	<input type="radio"/>	<input type="radio"/>	<input type="radio"/>	<input type="radio"/>	<input type="radio"/>	<input type="radio"/>

(1) compatible with power add on devices

(2) 136kg in combination with AGN090100 "Crash Test Option"

				£																
SEAT UPHOLSTERYS AND CUSHIONS																				
Seat Slings:																				
AGN020002	<input type="radio"/>	Seat sling with 1 utility bag	(Std default option)																	
AGN020003	<input type="checkbox"/>	Seat sling with 2 utility bag	(only from SW 34 cm)	£65																
AGN020004	<input type="checkbox"/>	Seat sling with utility bag and catheter bag	(only from SW 34 cm)	£135																
AGN020000	<input type="radio"/>	Without seat sling																		
Seat cushion black cover:																				
Foam composite: (medium soft)	Thickness:	AGN020101 <input type="checkbox"/> 3 cm	AGN020102 <input type="checkbox"/> 5 cm	£85																
Latex: (very soft)	Thickness:	AGN020103 <input type="checkbox"/> 5 cm		£85																
JAY Cushions - for complete product range see Jay order forms:																				
JAY020002	<input type="checkbox"/>	Jay Basic		£80																
JAY020001	<input type="checkbox"/>	Jay Easy Visco		£180																
JAY020007	<input type="checkbox"/>	JAY Easy Fluid		£470																
JAY020004	<input type="checkbox"/>	JAY Lite		£305																
Seat accessories																				
AGN090018	<input type="checkbox"/>	Positioning belt		£70																
###																				
BACKREST																				
Back height range		<table><tr><th>25 - 30</th><th colspan="2">30 - 40</th><th>40 - 45</th></tr><tr><td><input type="radio"/> 25</td><td><input type="radio"/> 30</td><td><input type="radio"/> 37.5</td><td><input type="radio"/> 40</td></tr><tr><td><input type="radio"/> 27.5</td><td><input type="radio"/> 32.5</td><td><input type="radio"/> 40</td><td><input type="radio"/> 42.5</td></tr><tr><td><input type="radio"/> 30</td><td><input type="radio"/> 35</td><td></td><td><input type="radio"/> 45</td></tr></table>			25 - 30	30 - 40		40 - 45	<input type="radio"/> 25	<input type="radio"/> 30	<input type="radio"/> 37.5	<input type="radio"/> 40	<input type="radio"/> 27.5	<input type="radio"/> 32.5	<input type="radio"/> 40	<input type="radio"/> 42.5	<input type="radio"/> 30	<input type="radio"/> 35		<input type="radio"/> 45
25 - 30	30 - 40		40 - 45																	
<input type="radio"/> 25	<input type="radio"/> 30	<input type="radio"/> 37.5	<input type="radio"/> 40																	
<input type="radio"/> 27.5	<input type="radio"/> 32.5	<input type="radio"/> 40	<input type="radio"/> 42.5																	
<input type="radio"/> 30	<input type="radio"/> 35		<input type="radio"/> 45																	
Choose back height factory setting (cm). Height adjustments possible in the range 25-30 cm; 30-40 cm; 40-45 cm.																				
AGN030015	<input type="radio"/>	Angle adj. Back (fold down)	(-31° to +15°)	(only available black anodized style package)																
AGN030102	<input type="checkbox"/>	Double locking		£90																
AGN030012	<input type="radio"/>	Angle adj. Back (fixed)	(-31° to +15°)	(only available black anodized style package)																
Push handles: Choose only one option																				
AGN030200	<input type="radio"/>	Without push handles																		
AGN030201	<input type="radio"/>	Integral push handles long																		
AGN030203	<input type="checkbox"/>	Fold-down push handles	(only available from back height 32.5 cm)	£165																
AGN030204	<input type="checkbox"/>	Height adj push handles	(only available from back height 32.5 cm)	£220																
AGN030205	<input type="checkbox"/>	Height adj push handles for Jay backs	(only available from back height 32.5 cm)	£220																
Backrest upholstery adjustable																				
AGN030316	<input type="radio"/>	EXO Backrest sling, synthetic fibre, padded, adjustable, 1 accessory bag, black (Exo Evo Version) Colour, binding tape: ● Black <input type="radio"/> Orange <input type="radio"/> Silver <input type="radio"/> Red <input type="radio"/> Blue																		
AGN030317	<input type="checkbox"/>	EXO PRO Backr. sling, synthetic fibre, padded, adj., breathable spacer fabric, accessory bag, black (Exo Evo Version) Colour, binding tape: ● Black <input type="radio"/> Orange <input type="radio"/> Silver <input type="radio"/> Red <input type="radio"/> Blue																		
AGN030000	<input type="radio"/>	Without backrest upholstery																		

										£						
JAY BACKS																
JAY 3 Carbon - Shallow Contour																
Low Thoracic:	<input type="checkbox"/>	JAY060001	Short - 17 cm			<input type="checkbox"/>	JAY060002	Tall - 24 cm	£845							
Mid Thoracic:	<input type="checkbox"/>	JAY060003	Short - 30 cm			<input type="checkbox"/>	JAY060004	Tall - 38 cm	£845							
JAY 3 Accessory bag																
JAY090058	<input type="checkbox"/>	JAY J3 Accessory bag							£60							
Jay 3 Back Headrests																
JAY030004	<input type="checkbox"/>	Jay Flip Back Headrest (J3EUHDFH & J3EUHDLSP)						(only with Jay 3 backs)	£345							
JAY030006	<input type="checkbox"/>	Jay Std. Headrest (J3EUHDXH & J3EUHDLSP)						(only with Jay 3 backs)	£235							
SIDEGUARDS & ARMRESTS																
AGN040107	<input type="radio"/>	Plastic detachable sideguard														
AGN040102	<input type="checkbox"/>	Straight aluminium sideguard								£230						
AGN040103	<input type="checkbox"/>	Straight aluminium sideguard with fender								(min seat height 39 cm)	£315					
AGN040101	<input type="checkbox"/>	Straight carbon slim style sideguard								(1)	£260					
AGN040104	<input type="checkbox"/>	Straight carbon sideguards with fender								1926 ndbike axle)	£395					
AGN040108	<input type="checkbox"/>	Padded tubular armrest								(not in combination with handbike axle)	£160					
Single post armrest with:										(Quickie style)						
AGN040050	<input type="checkbox"/>	short armpad (25 cm)			AGN040051	<input type="checkbox"/>	long armpad (36 cm)			£180						
AGN040052	<input type="checkbox"/>	Tool height adj. armrest (short & long armpad - length adj.)								£180						
AGN040000	<input type="radio"/>	Without Sideguard														
LEGREST & FOOTPLATES																
AGN050029	<input type="radio"/>	Tubular footrest lightweight								(lower leg length 36 cm - 50 cm)						
AGN050030	<input type="checkbox"/>	Tubular footrest lightweight with flat cover								(lower leg length 36 cm - 50 cm)	£95					
AGN050025	<input type="checkbox"/>	Platform footrest lightweight composite plate								(lower leg length 36 cm - 50 cm)	£285					
AGN050024	<input type="checkbox"/>	Platform footrest lightweight alu plate								(lower leg length 36 cm - 50 cm)	£285					
AGN050026	<input type="checkbox"/>	Platform footrest lightweight carbon plate								(lower leg length 36 cm - 50 cm)	£460					
AGN050034	<input type="checkbox"/>	Platform footrest lightweight high mount								(LLL 22 - 39 cm)	£285					
AGN050125	<input type="checkbox"/>	Performance footrest alu angle adj.								(lower leg length 36 cm - 50 cm)	£285					
AGN050127	<input type="checkbox"/>	Foot positioning plate								(only with platform footplates lightweight angle & depth adjustable)	£30					
AGN050020	<input type="checkbox"/>	Composite footplate divided								(2) (SW 38-50cm; LLL 38 - 50 cm)						
AGN050022	<input type="checkbox"/>	Alu footplate divided								(2) (SW 34 - 50; lower leg length 38 cm - 50 cm)	£120					
Lower leg length (LLL) Attention: LLL has to be 3 cm less than seat height front; all measurements are in cm																
<input type="radio"/>	22	<input type="radio"/>	23	<input type="radio"/>	24	<input type="radio"/>	25	<input type="radio"/>	26	<input type="radio"/>	27	<input type="radio"/>	28	<input type="radio"/>	29	
<input type="radio"/>	30	<input type="radio"/>	31	<input type="radio"/>	32	<input type="radio"/>	33	<input type="radio"/>	34	<input type="radio"/>	35	<input type="radio"/>	36	<input type="radio"/>	37	
<input type="radio"/>	38	<input type="radio"/>	39	<input type="radio"/>	40	<input type="radio"/>	41	<input type="radio"/>	42	<input type="radio"/>	43	<input type="radio"/>	44	<input type="radio"/>	45	
<input type="radio"/>	46	<input type="radio"/>	47	<input type="radio"/>	48	<input type="radio"/>	49	<input type="radio"/>	50							
LLL 22 - 35 cm only with high mounted footrest; for all other footrests from LLL 36 - 50 cm.																
FRAME VERSIONS (first choose frame angle then frame inset)																
AGN010601	<input type="radio"/>	User Weight max.125kg														
AGN010602	<input type="radio"/>	User Weight max.140kg														
AGN010013	<input type="radio"/>	Fixed frame 88° (EU 92 degree)														
AGN010012	<input type="radio"/>	Fixed frame 80° (EU 100 degree)														
AGN010100	<input type="radio"/>	Frame inset: 0cm														
AGN010103	<input type="radio"/>	Frame inset: 3cm														
AGN090015	<input type="checkbox"/>	Preparation for add on devices (4)												(max. 120 kg; only 0° camber)	£220	
AGN010500	<input type="checkbox"/>	Handbike axle				(3)	(max 100kg; not in combination with amputee axle and padded tubular armrest)							£365		
AGN070500	<input type="checkbox"/>	Amputee axle				(not in combination with handbike axle and padded tubular armrest)										£220
(1)	With 24" rear wheel minimum rear seat height 41 cm; with 25" rear wheel minimum rear seat height 43 cm															
(2)	With 3 cm inset divided footplates are available from sw 40 composite and SW 36 alu footplate															
(3)	Not with tip assist															
(4)	Necessary for e-fix or P105 attachment															

				£
AXLE PLATE & CENTRE OF GRAVITY (COG)				(measured from front of back post; choose only one option)
COG32	<input type="radio"/>	3.2 cm	COG80	<input type="radio"/> 8.0 cm (Sport or pair of anti tip tubes only)
COG44	<input type="radio"/>	4.4 cm	COG92	<input type="radio"/> 9.2 cm (Sport or pair of anti tip tubes only)
COG56	<input type="radio"/>	5.6 cm	COG104	<input type="radio"/> 10.4 cm (Sport or pair of anti tip tubes only)
COG68	<input type="radio"/>	6.8 cm		
FRAME ACCESSORIES				(choose either tip assist or anti- tip tubes, not both)
<b>Tip assist (step tube)</b>				
AGN090001	<input type="checkbox"/>	Left	AGN090002	<input type="checkbox"/> Right
AGN090003	<input type="checkbox"/>	Pair		
AGN090009	<input type="checkbox"/>	Crutch holder		(only in combination with tip assist)
<b>Anti-tip tubes swing-away</b>				
AGN090004	<input type="checkbox"/>	Left	AGN090005	<input type="checkbox"/> Right
AGN090006	<input type="checkbox"/>	Pair		
<b>Anti-tip tubes pluggable</b>				
AGN090007	<input type="checkbox"/>	Anti-tip tubes pluggable		(Pair) £95
<b>Anti tip flip up (user operated)</b>				
AGN090033	<input type="checkbox"/>	Left	AGN090008	<input type="checkbox"/> Right
AGN090035	<input type="checkbox"/>	Sport anti-tip (4)		
AGN090010	<input type="checkbox"/>	Transit wheels		(3") £235
AGN090016	<input type="checkbox"/>	Frame protection (impact guard)		£85
EMPULSE F55 BUNDLING				1926
EMO000101	<input type="radio"/>	With F55 order, not mounted to the wheelchair		(Please use separate OF to order the F55.)
EMO000102	<input type="radio"/>	With F55 order, mounted to the wheelchair		(Please use separate OF to order the F55.)
PREPARATION FOR ATTITUDE ADD-ON BIKE				
AGN090211	<input type="checkbox"/>	Preparation for ATTITUDE, w/o ATTITUDE order (3)		(docking pins assembled) £125
AGN090212	<input type="radio"/>	Preparation for ATTITUDE, with ATTITUDE order (3)		(docking pins assembled; ATTITUDE order separately)
FORKS				(compare with your choice on the first page)
AGN080013	<input checked="" type="radio"/>	Carbotecture fork (111mm forks only)		(colours: see Stylepackage on last page)
AGN080029	<input checked="" type="radio"/>	Aluminium fork (123mm forks only) (1)		(colours: see Stylepackage on last page)
AGN080007	<input type="checkbox"/>	FROG LEG fork		(not in combination with 3" & all ALU casters; only black, max user weight 125 kg) £365
STANDARD CASTOR				(compare with your choice on the first page)
AGN080301	<input type="radio"/>	Solid		
AGN080302	<input type="radio"/>	Soft		(only for 5" & 6")
AGN080304	<input type="checkbox"/>	Solid with aluminium rim		(only for 4" and 5") £105
AGN080306	<input type="checkbox"/>	Soft with aluminium rim (wide)		(only for 4" and 5") £105
REAR WHEELS				(compare with your choice on the first page; choose only one wheel type)
<b>NOTE: for users with higher user weight than 100 kg, we recommend cross spoked wheels</b>				
AGN070001	<input type="radio"/>	Universal Cross spoked		(not with 25")
AGN070002	<input type="radio"/>	Design wheel		(not with 22" or 25")
AGN070003	<input type="radio"/>	Lightweight wheel		(not with 26"; max user weight: 125 kg) £90
AGN070004	<input type="checkbox"/>	Proton Wheels		(not with 26"; max user weight: 100 kg) £250
AGN070005	<input type="checkbox"/>	Spinergy wheels 18 spokes		(not with 22"; black spokes; other colours available via B4M) £495
AGN070009	<input type="checkbox"/>	Mountainbike Rear wheel		(only with 24", mountain bike tyres & aluminium rim, black coated) £360
AGN070010	<input type="checkbox"/>	Additional Mountain Bike wheels		(only with 24"; comes always with mountainbike tyres ) £585
AGN070000	<input type="radio"/>	Without wheels		
TYRES				(choose only one tyre type)
AGN070101	<input type="radio"/>	Right Run (standard slick)		(not in 25")
AGN070102	<input type="radio"/>	Solid tyres (puncture proof) (2)		(not with 26")
AGN070107	<input type="checkbox"/>	Schwalbe One (Slight puncture protection)		(only 24") £115
AGN070104	<input type="checkbox"/>	Marathon plus evolution (puncture resistant)		(not in 22") £95

(1) compatible with power add on devices

(2) Proton and Light Weight wheel only with 24" & 25"solid tyre ; Spinergy wheels only with 24" solid tyre

(3) Max front frame width 46cm, max 100kg user weight

(4) Not with 22" rear wheel

				£
HANDRIM				
AGN070202	<input type="radio"/>	Aluminium silver anodized	(1)	
AGN070201	<input type="radio"/>	Aluminium silver powder coated	(1)	(not with 26" and Spinergy wheels)
AGN070204	<input type="radio"/>	Stainless steel		(not with 25" wheels; not with Spinergy wheels) £100
AGN070203	<input type="checkbox"/>	Aluminium colour powder coated	Colour Code: .....	(not with Spinergy wheels)
AGN070205	<input type="checkbox"/>	Titanium		(only 24", 26" wheels; not with Spinergy wheels) £240
AGN070206	<input type="checkbox"/>	Titanium clear powdercoated		(only 24" wheels; not with Spinergy wheels) £240
AGN070207	<input type="checkbox"/>	Supergrip		( Not with mountain bike wheels) £250
AGN070208	<input type="checkbox"/>	Max Grepp		(only 22", 24"wheels; not with Spinergy wheels) £350
AGN070212	<input type="checkbox"/>	Handrims, Ellipse 3R, black		(ergonomic handrims with rubber-strip; only 24" and 25") £125
AGN070250	<input type="checkbox"/>	Handrim cover		(only 22" & 24"wheels) £110
Handrim mounting	AGN070317	<input type="radio"/>	Close = 17mm	(12,5 mm with lightweight & Proton wheels)
	AGN070327	<input type="radio"/>	Wide = 27mm	(not with lightweight & spinergy wheel and alu handrim)
	AGN070307	<input type="radio"/>	Extra close = 7mm	(only with stainless steel)
WHEEL CAMBER (choose only one option)				
AGN070600	<input type="radio"/>	0°		
AGN070603	<input type="radio"/>	3°		
AGN070606	<input type="radio"/>	6°		
AGN070609	<input type="radio"/>	9°		(not with handbike axle)
SPOKE GUARDS (only available in 22" & 24")				
<input type="checkbox"/>	Spoke guards	Number:		Description: £150
Please consult the following page of this order form to choose your selection or to order a copy of our brochure please call 0845 605 66 88 or e-mail literaturerequest@sunmed.co.uk.				
You can also view the brochure online by visiting <a href="http://www.sunrisemedical.com">www.sunrisemedical.com</a> and navigating to Quickie Argon. You will find the brochure under "Multimedia & Downloads".				
WHEEL LOCKS (Choose only one option)				
AGN060001	<input type="radio"/>	Standard wheel lock		
AGN060023	<input type="radio"/>	Compact wheel lock		(only with 0°/3° camber) £65
AGN060002	<input type="checkbox"/>	Knee lever wheel lock		£95
AGN060010	<input type="checkbox"/>	Wheel lock extension knee lever brake lock		(only on knee lever wheel lock) £50
AGN060006	<input type="checkbox"/>	One arm wheel lock left		(only with 0°/3° camber) £200
AGN060007	<input type="checkbox"/>	One arm wheel lock right		(only with 0°/3° camber) £200
ACCESSORIES				
AGN090000	<input checked="" type="radio"/>	Tool kit		
AGN090100	<input checked="" type="radio"/>	Transportation brackets - Crash Test Option (3)		Std.
AGN090024	<input type="checkbox"/>	High pressure pump		£90
AGN090025	<input type="checkbox"/>	Air pump		£20
AGN090030	<input type="checkbox"/>	Back pack		£75
AGN090026	<input type="checkbox"/>	Mobile phone pocket		£55

(Max user weight: 100kg)

(1) Not available mounting wide with Lightweight & Proton wheels  
(2) Not in combination with performance footrest and high mounted footrest  
(3) max. user weight 136kg

● = Standard

○ = No cost option

□ = Cost option

**COLOURS**

Please consult our colour catalogue, to review your colour choice at the end of the order form

	Frame	Handrim	Hub/rim	(1)		Frame	Handrim	Hub/rim	(1)
		£75	£200				£75	£200	
01 Matte Black	○	□	□		20 Mystic Purple	○		□	
02 Gloss Black	○	□	□		22 Velocity Yellow	○		□	
03 Metallic Shadow	○	□			09 Salute Green	○	□		
04 Starlight White	○	□			10 Velvet Sapphire	○	□		
05 Silver Ore	○	□			13 Brilliant Ocean	○	□		
06 Storm Gray	○	□			16 Cherry Lustre	○	□	□	
07 Desert Tan	○	□			18 Pink Power	○	□		
08 Desert Sage	○	□			19 Satin Rose	○	□		
11 Midnight Blue	○	□			21 Solar Orange	○	□		
12 Royal Blue	○	□	□						
14 Scarlet Noir	○	□							
15 Red Pepper	○	□	□						
17 Turbo Green	○	□							

**Style Package** (Colours for Forks)

AGN100502 ● Black

AGN100503 □ Silver

AGN100501 □ Orange

**(1) only with universal cross spoked rear wheels****Comments for special build:**

<b>Argon<sup>2</sup> - Base Price</b>	<b>£2,095</b>
Option price	£
Packaging and transport	£
Exclusive VAT	£
VAT.	£
<b>Total Price</b>	<b>£</b>

DONE



110

73

207



101

101





**HUM070823 - Princess**



**HUM070819- Monkeys**



**HUM070818 - Jungle Fever**



**HUM070816 - Happy Lions**



**HUM070820 - Oriental**



**HUM070829 - Superhero**



**HUM070814 - Graffiti**



**HUM070821 - Pirates**



**HUM070811 - Feather**



**HUM070806 - Chrome Wheel**



**HUM070817 - Hot Wheels**



**HUM070802 - Basketball**



**HUM0708036 - Basketball 2**



**HUM070822 - Pool**



**HUM070812 - Flying Water**



**HUM070828 - Space**



**HUM070827 - Silk**



**HUM070833 - Zebra**



**HUM070813 - Galactica**



**HUM070830 - Tiger**



### Please follow this measuring method:

The following method is recommended on the basis of extensive practical experience. Deviations are possible in individual instances.

#### Seat width (SW):

a) For the user:

Allow space between sideguard and hip on each side of the chair  
(approx. 1 - 2cm altogether)

b) On the wheelchair:

From outside frame tube to outside frame tube.

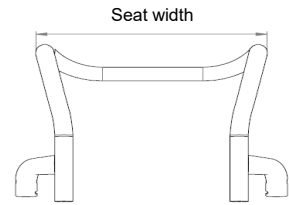

#### Seat depth (SD):

a) For the user:

When sitting upright: leave space for 2 - 3 fingers between  
front edge of the seat upholstery and back of knee  
(approx. 3 - 6 cm). Care must be taken with adj. upholstery.

b) On the wheelchair:

From back tube to front of seat upholstery.

#### Front seat height:

a) For the user:

When sitting with 90° knee angle:  
From back of knee to bottom of shoe sole.

b) On the wheelchair:

From front of seat tube to the ground .  
(min. 3cm longer than user measurement)  
Remember to include the cushion height.

##

#### Rear seat height:

b) On the wheelchair:

From back of seat tube to the ground.

**Note:** Max. seat height difference rear to front is 13 cm

#### Back height:

a) For the user:

From the seat, including cushion, to be no more than 1 - 2 cm below the lower shoulder blade.

b) On the wheelchair:

From back of seat tube to upper edge of backrest upholstery.

**Note:** The user's ability to sit upright has a major influence on the  
back height and it can therefore differ considerably

#### Back angle:

**Important:** The back height depends on the degree of disability.  
0° is the angle 90° to the ground. Negative angles are <90°  
and positive angles are >90°.

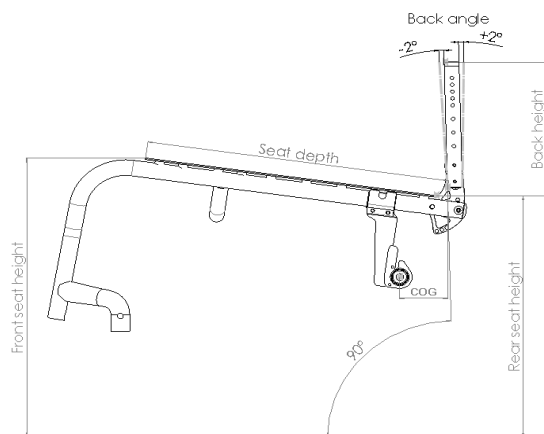

### Technical Data Overview:

#### Overall dimensions:

Max overall height: 90 cm  
Max overall length: 91 cm

#### Overall width with:

For 0° camber:  
For 3° camber:  
For 6° camber:  
For 9° camber:

#### 24" rear wheel

SW + 20 cm  
SW + 22 cm  
SW + 28 cm  
SW + 34 cm

#### 25" rear wheel

SW + 20 cm  
SW + 26 cm  
SW + 32 cm  
SW + 38 cm

Please note that the matrix is based on a std configuration:

**Std chair 40 x 40 cm; 3° camber; 5,60 cm CoG; Seat angle of 8°**

All changes in the configuration might change the seat heights.

Manufacturing tolerances of +/- 1 cm



AGN020002  
Seat sling with 1 utility bag



AGN090018  
Positioning Belt



JAY020002  
JAY Basic  
(picture shown without upholstery)



JAY020001  
JAY Easy Visco  
(picture shown without upholstery)



JAY020004  
JAY Lite  
(picture shown without upholstery)



AGN030201  
Integral push handles  
long



AGN030203  
Fold down push  
handles



AGN030205  
Height adjustable  
push handles for Jay



AGN030316  
EXO backrest sling



AGN030317  
EXO PRO backrest sling



AGN040102  
Aluminium sideguard w/o  
fender



AGN040101  
Slim style sideguard



AGN040103  
Aluminium sideguard  
with fender



AGN040104  
Carbon sideguard with  
fender



AGN040107  
Composite  
sideguard  
detachable



AGN040108  
Padded tubular  
armrest



AGN040051  
Single post armrest  
with long armpad



AGN040052  
Tool height adj. armrest

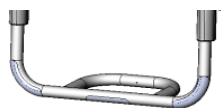

AGN050029  
Tubular footrest  
lightweight



AGN050030  
Tubular footrest lightweight  
with flat cover



AGN050025  
Platform footrest LW  
composite plate



AGN050026  
Platform footrest LW  
carbon plate



AGN050125  
Performance  
footrest alu angle  
adj



AGN050127  
Foot positioning plate



AGN050020  
Composite footplate  
divided



AGN050022  
Alu footplate divided

Frame inset table (Graphs below are showing an example for SW 34)

		Seat Width (cm)										
Inset		30	32	34	36	38	40	42	44	46	48	50
0 cm	Frame Width Inside	24	26	28	30	32	34	36	38	40	42	44
	Frame Width Casterhouse	41	43	45	47	49	51	53	55	57	59	61
3cm	Frame Width Inside	NA	NA	22	24	26	28	30	32	34	36	38
	Frame Width Casterhouse	NA	NA	40	42	44	46	48	50	52	54	56

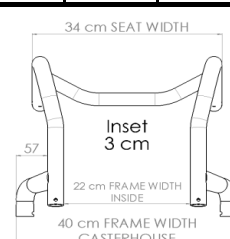
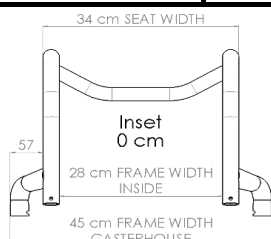



AGN090001  
Tip assist left



AGN090004  
Anti-tip tubes SA



AGN090007  
Anti tip tubes pluggable



AGN090035  
Sport anti-tip



AGN090008  
Anti tip flip up  
User operated



AGN090010  
Transit wheels



AGN090016  
Frame protection



AGN080013  
Carbotecture fork



AGN080007  
FROG LEG fork



AGN070001  
Universal Cross spoked



AGN070002  
Design Wheel



AGN070003  
Light weight wheel



AGN070004  
Proton Wheel



AGN070005  
Spinergy Wheel - 18 spoke



AGN070101  
Right Run



AGN070107  
Schwalbe One



AGN070102  
Solid Tyres



AGN070104  
Marathon Plus  
(puncture proof)



AGN070009  
Mountain bike rear  
wheel

## F55 BUNDLING - NOGO MATRIX FOR 24" BACKWHEELS

COG	Seat Depth						
	380	400	420	440	460	480	500
40	✗	✗	✗	✓	✓	✓	✓
60	✗	✗	✗	✗	✓	✓	✓
70	✗	✗	✗	✗	✓	✓	✓
80	✗	✗	✗	✗	✗	✓	✓
90	✗	✗	✗	✗	✗	✓	✓
100	✗	✗	✗	✗	✗	✗	✓
110	✗	✗	✗	✗	✗	✗	✓
120	✗	✗	✗	✗	✗	✗	✗
130	✗	✗	✗	✗	✗	✗	✗



*AGN070208  
Max Grepp*



*AGN070207  
Supergrip*



*AGN070212  
Ellipse 3R*



*AGN060001  
Standard Wheel lock*



*AGN060003  
Compact wheel lock*



*AGN060002  
Knee lever wheel lock*



*AGN060007  
One arm wheel lock  
right*



*AGN090000  
Tool kit*



*AGN090024  
High pressure pump*



*AGN090025  
Air pump*



*AGN090030  
Back pack*



*AGN090026  
Mobile phone pocket*